

PROPOSED INTERNAL LAYOUT PLAN OF Z.O - SALT LAKE ,IN BIDYUT BHAWAN AT KARUNAMOYEE ,FOR UCO BANK

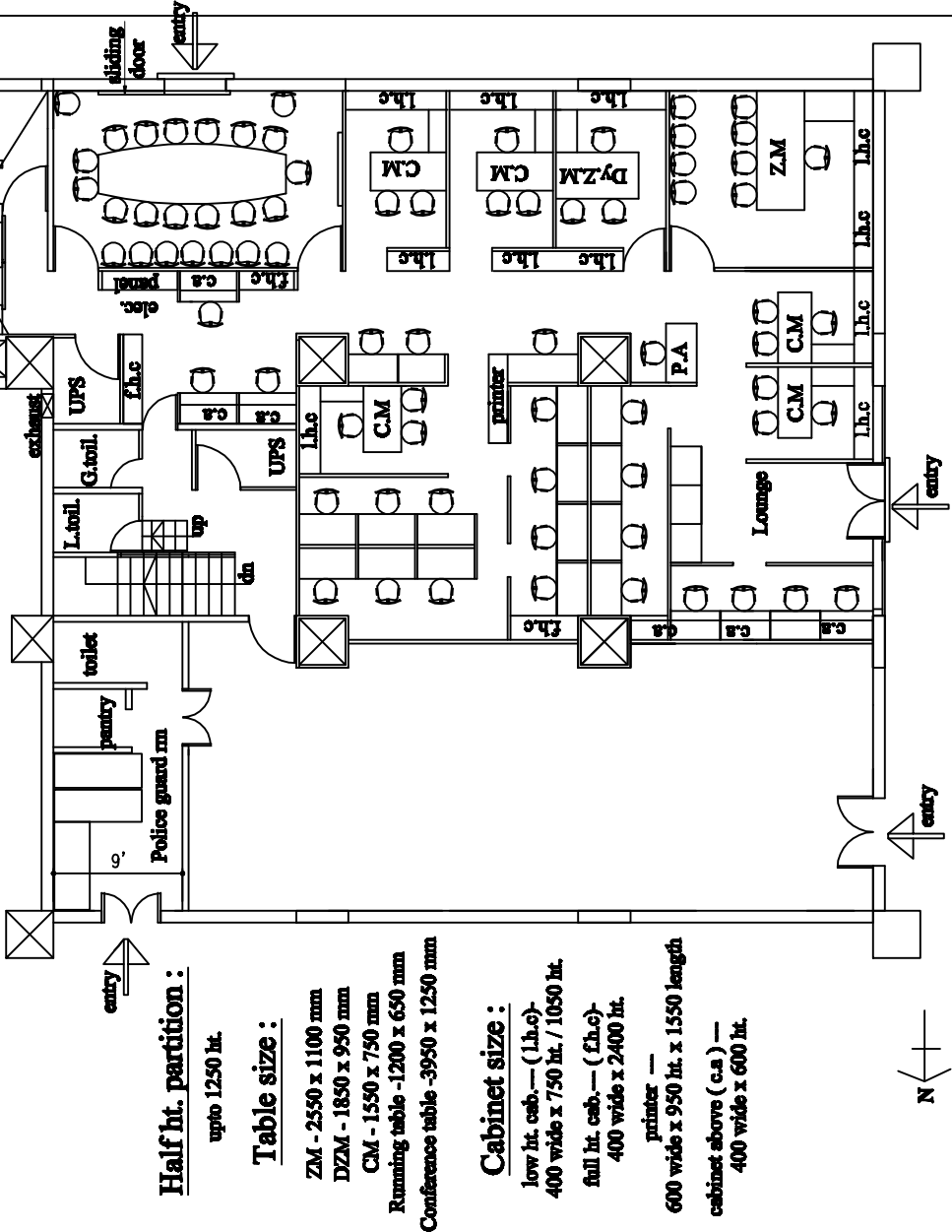

Half ht. partition :
upto 1250 ht.

Table size :
ZM - 2550 x 1100 mm
DZM - 1850 x 950 mm
CM - 1550 x 750 mm
Running table -1200 x 650 mm
Conference table -3950 x 1250 mm

Cabinet size :
low ht. cab.-- (l.h.c)-
400 wide x 750 ht. / 1050 ht.
full ht. cab.-- (fh.c)-
400 wide x 2400 ht.
printer --
600 wide x 950 ht. x 1550 length
cabinet above (c.a) --
400 wide x 600 ht.

GROUND FLOOR PLAN

SCHEME- 2A approved. dt. 04.03.2023

low ht. cab.-- (l.h.c)
full ht. cab.-- (fh.c)
cabinet above -- (c. a)